

NEW TO RANGE

MDSP-103-2021



CATERPILLAR

CAT C Series Perkins EUI Injector Parts Catalogue



DISCOVER

DIESEL

EXCELLENCE

Tel: +44 (0) 1772 694185

testequipment@merlindiesel.com



www.merlindiesel.com

Manufacturer's part numbers are given for reference purposes only and do not imply that in all cases the parts are of their manufacture. Illustrations and Technical Data are non-binding and are subject to change as a result of technological progress.

EUI, HEUI & Common Rail Test Stands	Page 2
Training & Tooling	Page 3
Cross Reference Numbers	Page 4-5
276-8307 (10R7231)	Page 6
253-0618 (10R2772)	Page 7
295-9085 (10R8988)	Page 8
374-0750 (20R2284)	Page 9
253-0616 (10R3265)	Page 10
211-3028 (10R7228)	Page 11
374-0751 (20R2285)	Page 12
CH10948	Page 13
CH11945	Page 14
CH12071	Page 15
249-0713 (10R3262)	Page 16
356-1367 (10R1273)	Page 17
229-5919 (10R1000)	Page 18
211-3024 (10R8502)	Page 19
211-3023 (10R8501)	Page 20
249-0708 (10R2977)	Page 21
CH12082	Page 22
212-3460 (10R0960)	Page 23
212-3463 (10R0963)	Page 24
211-3022 (10R0956)	Page 25
211-3025 (10R0955)	Page 26
Parts Index	Page 27
Parts Kit Index	Page 28-29

HARTRIDGE HK1400 EXPERT CAM-BOX



HK1400 EUI APPLICATIONS

VOLVO	E3, E1, A SERIES
LAND ROVER	TD5
JOHN DEERE	E1, A SERIES
VOLVO BOSCH	A SERIES
CAT EUI	C10, C12, C15, C18, C27, C32, 3500
SCANIA	11, 12, 16
IVECO	CURSOR 8, 10, 13, E1
DETROIT DIESEL	SERIES 60 N2, N3
VW	PD, PDB, PPD (PIEZO)
CUMMINS	CELECT
NISSAN	BOSCH, GEI3
DELPHI	DAF EUP
BOSCH	MACK, MB ACTROS, MB ATEGO, VOLVO

MERLIN S9000 MKII



S9000 MK II APPLICATIONS

CATERPILLAR	3408, 3412, 3126A, 3126B, C7/C9 HEUI
NAVISTAR	DT446E, DT530E HEUI
FORD POWERSTROKE	POWERSTROKE 3126 TYPE
BOSCH	COMMON RAIL INJECTORS
DELPHI	COMMON RAIL INJECTORS
DENSO	COMMON RAIL INJECTORS
CONTINENTAL	COMMON RAIL INJECTORS

HARTRIDGE TOLEDO HEUI MASTER



TOLEDO APPLICATIONS

FORD POWERSTROKE	4.5L V6, 6.0L V8, 7.3L V8
NAVISTAR	DT444E, DT446E, DT530E, DT570- HT570, VT275, VT365
ISUZU	4JX1
CATERPILLAR	3408, 3412, 3116E, 3126A, 3126B, C7,C9

For more information on the specifications for the test solutions, please request a brochure or visit merlindiesel.com

Training & Tooling Solutions at Merlin Diesel

Merlin Diesel's extensive Research and Development programme in the field of EUI and HEUI has led to a surge of interest from technicians worldwide. The need for a qualified and skilled work force is essential for garage and workshop productivity.



In response to this demand Merlin have created a state-of-the-art training facility dedicated to providing an in-depth understanding of the processes involved in effective, inspection, fault diagnosis, fault correction, re-calibration and test.

All courses cover theory and practical demonstrations, equipping technicians with the practical skill to effectively identify faults and repair the relevant unit by the course's completion.

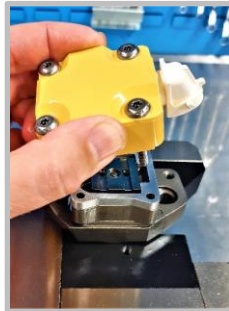

We provide comprehensive tool kits to compliment the courses we are offering. The tool kits cover a complete disassembly and assembly process for all the modules in the prospectus. The kits contain tools for the following technologies:

Technologies & Brand			
Bosch CRI/CRIN	Denso/VDO CRI	CAT CRI & CRP	Delphi Technologies EUI
Bosch EUI/EUP	All Makes HEUI	CAT EUI	Delphi Technologies/CAT EUI (Valve Kit)
Detroit Diesel EUI	Bosch EUI/EUP (Valve Kit)		

Merlin courses are open to all - Competitive pricing policy - Access post-training support

For more information please contact: testequipment@merlindiesel.com

Cross Reference Numbers

Page	Current	Current	Alternative	Alternative	Alternative	Alternative
6	276-8307	10R7231	253-0597			
7	253-0618	10R2772	244-7718			
8	295-9085	10R8988				
9	374-0750	20R2284	244-7715	253-0615	10R3264	
10	253-0616	10R3265	244-7716			
11	211-3028	10R7228	200-1120	20R1936		
12	374-0751	20R2285	253-0617	10R3266		
13	CH10948		CH11073	CH10793		
14	CH11945		CH11998			
15	CH12071					
16	249-0713	10R3262				
17	356-1367	10R1273	249-0709	232-1199	239-4909	
18	229-5919	10R1000	223-5329			
19	211-3024	10R8502	118-9035	10R0958	10R2780	102-6230
19	211-3024	10R8502	117-1148	152-3680	191-3004	176-1145
20	211-3023	10R8501	118-8010	191-3003	0R9257	10R0957
20	211-3023	10R8501	102-2014	109-5021	117-0482	118-9030
20	211-3023	10R8501	159-2479	140-8993	103-4562	

C Series EUI Injector Parts



276-8307

10R7231

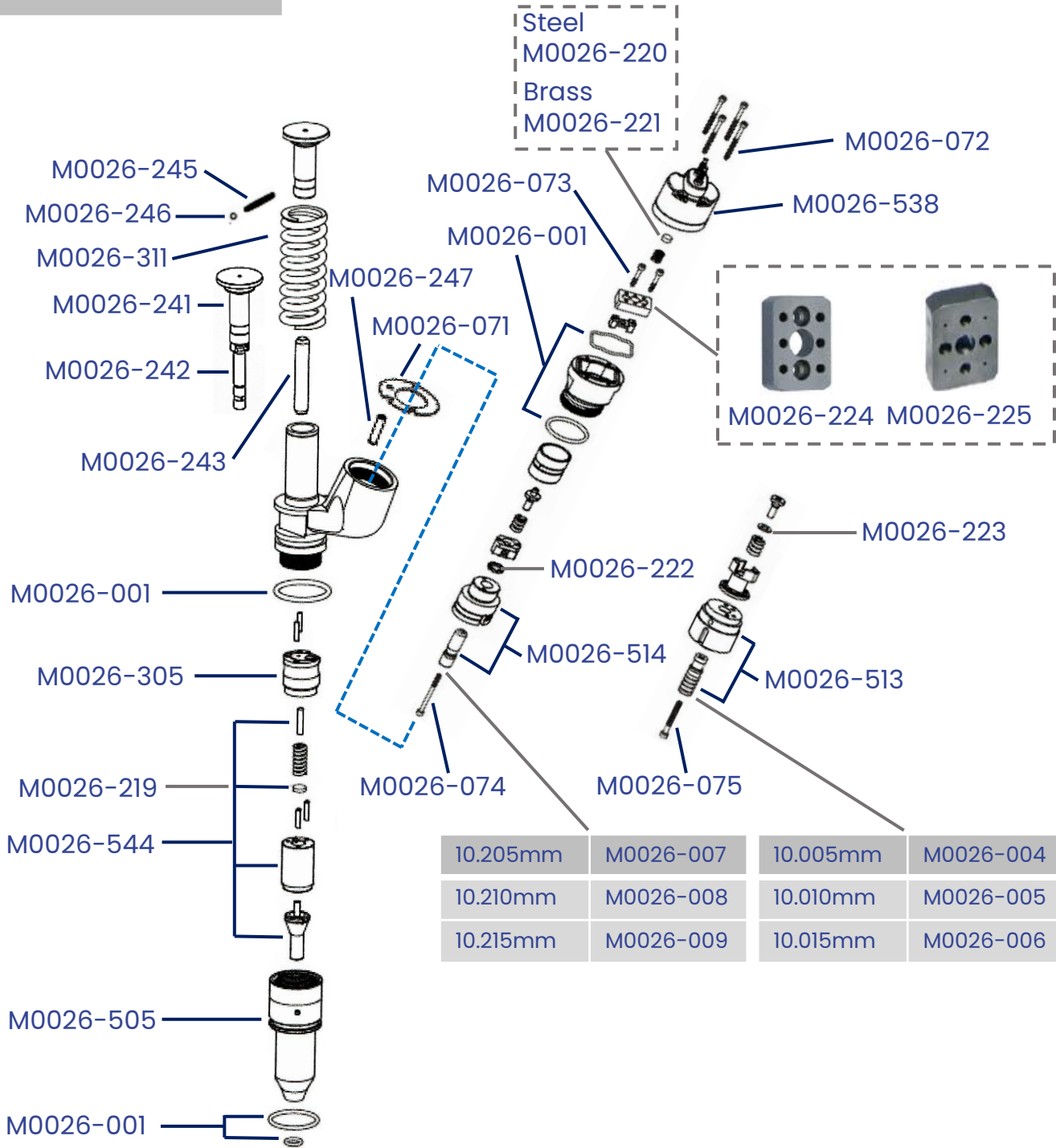

C Series EUI Injector Parts



253-0618

10R2772

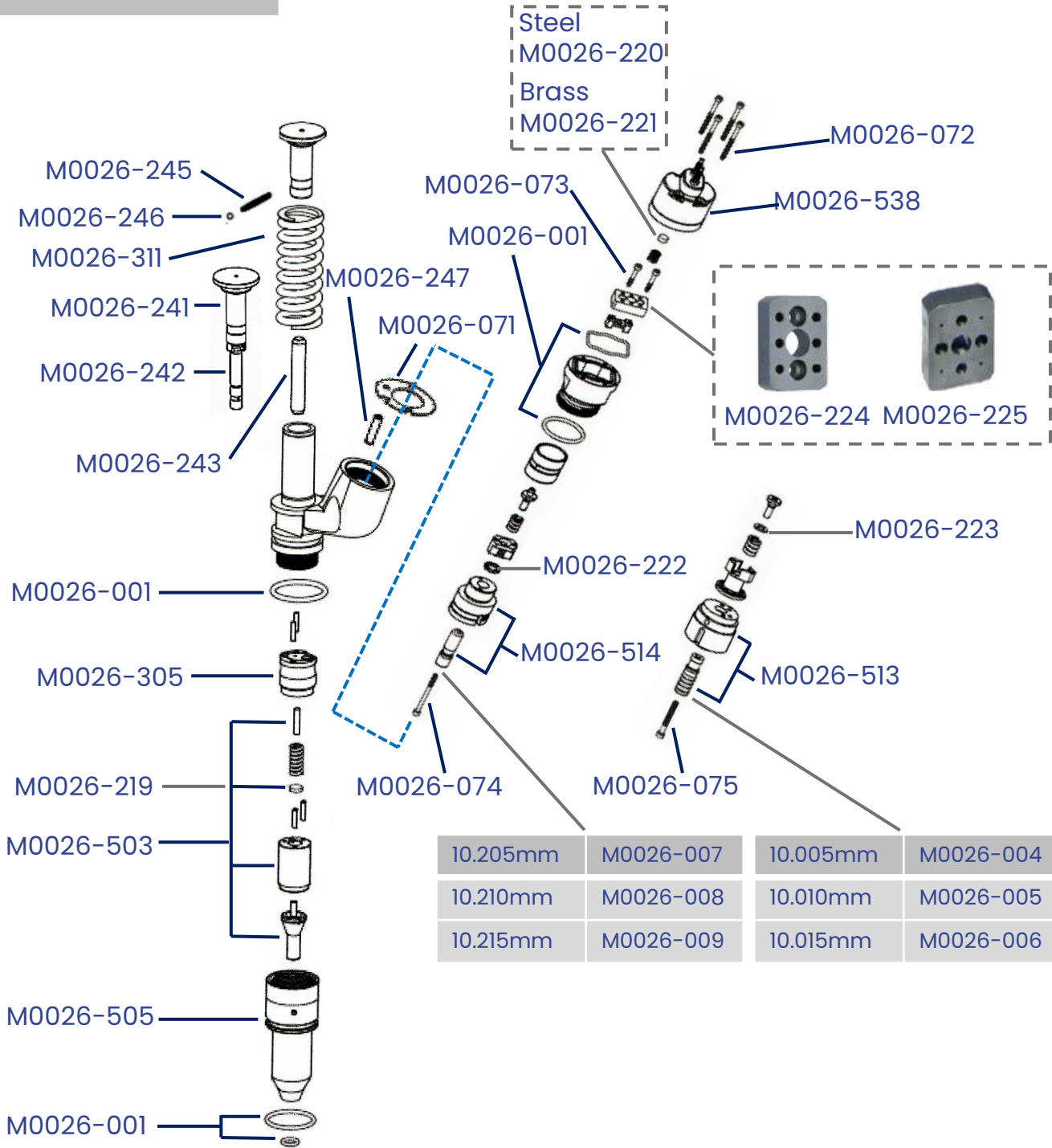

C Series EUI Injector Parts



295-9085

10R8988

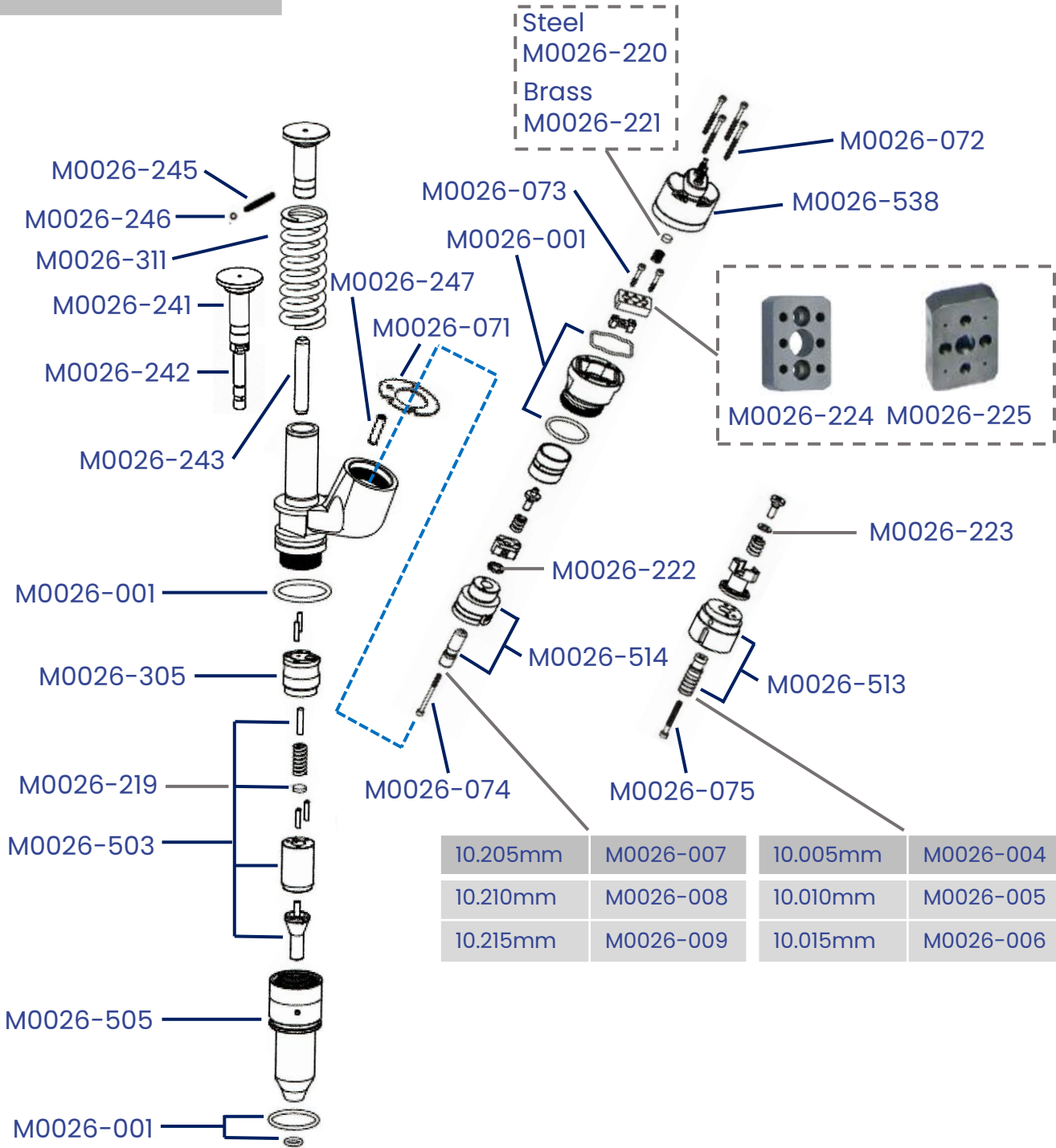

C Series EUI Injector Parts



374-0750

20R2284

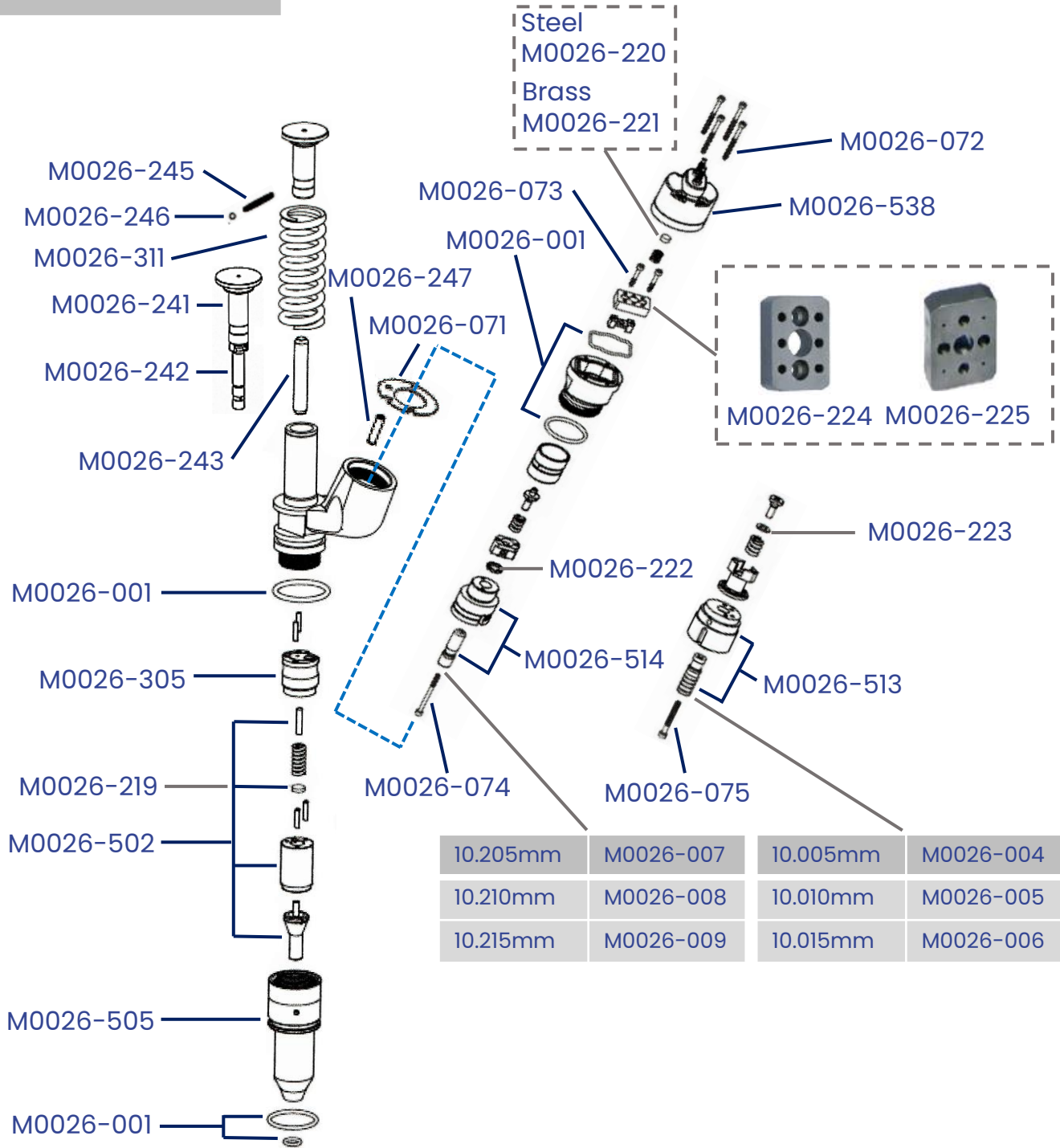

C Series EUI Injector Parts



253-0616

10R3265

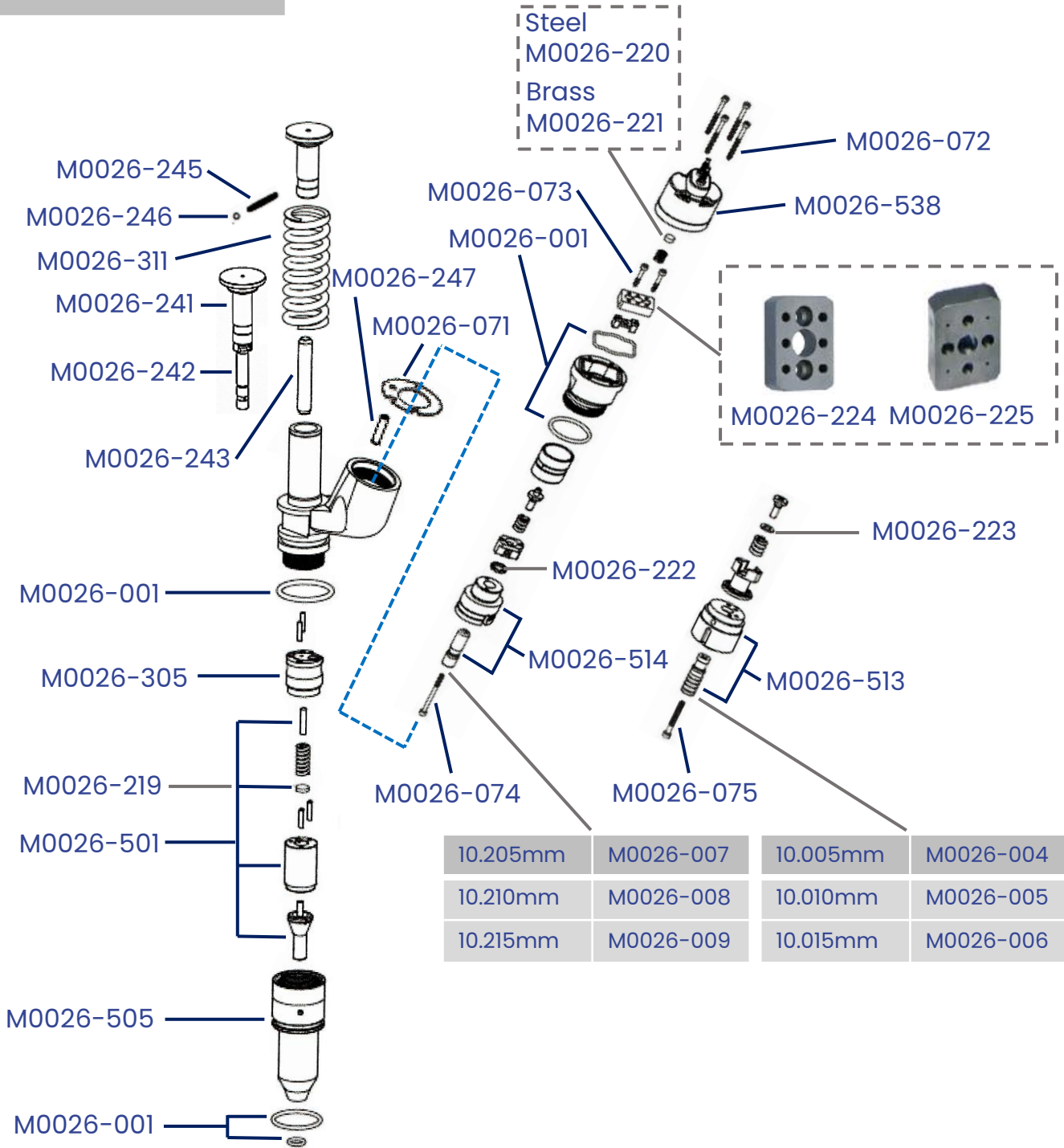

C Series EUI Injector Parts



211-3028

10R7228

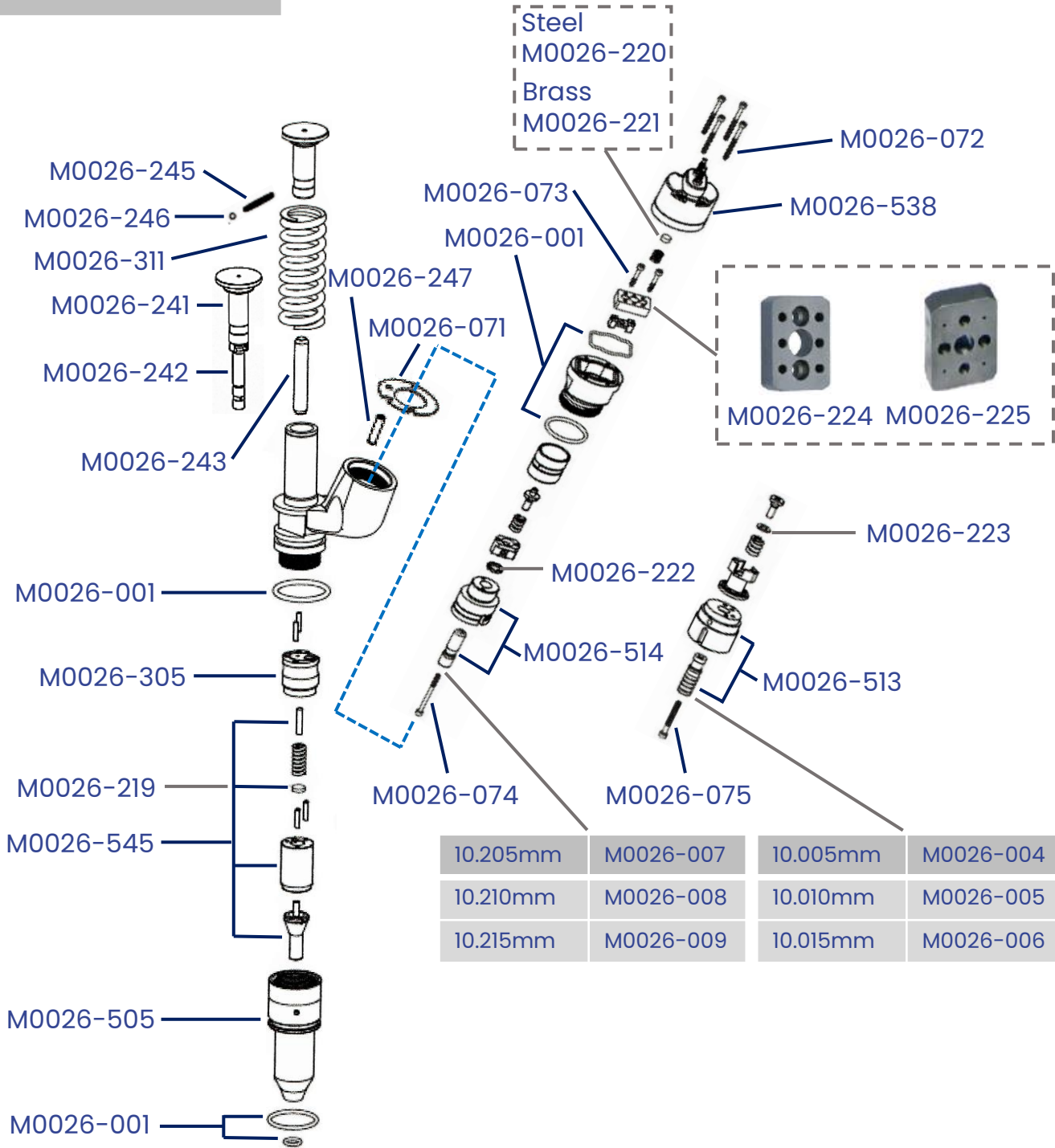

C Series EUI Injector Parts



374-0751

20R2285

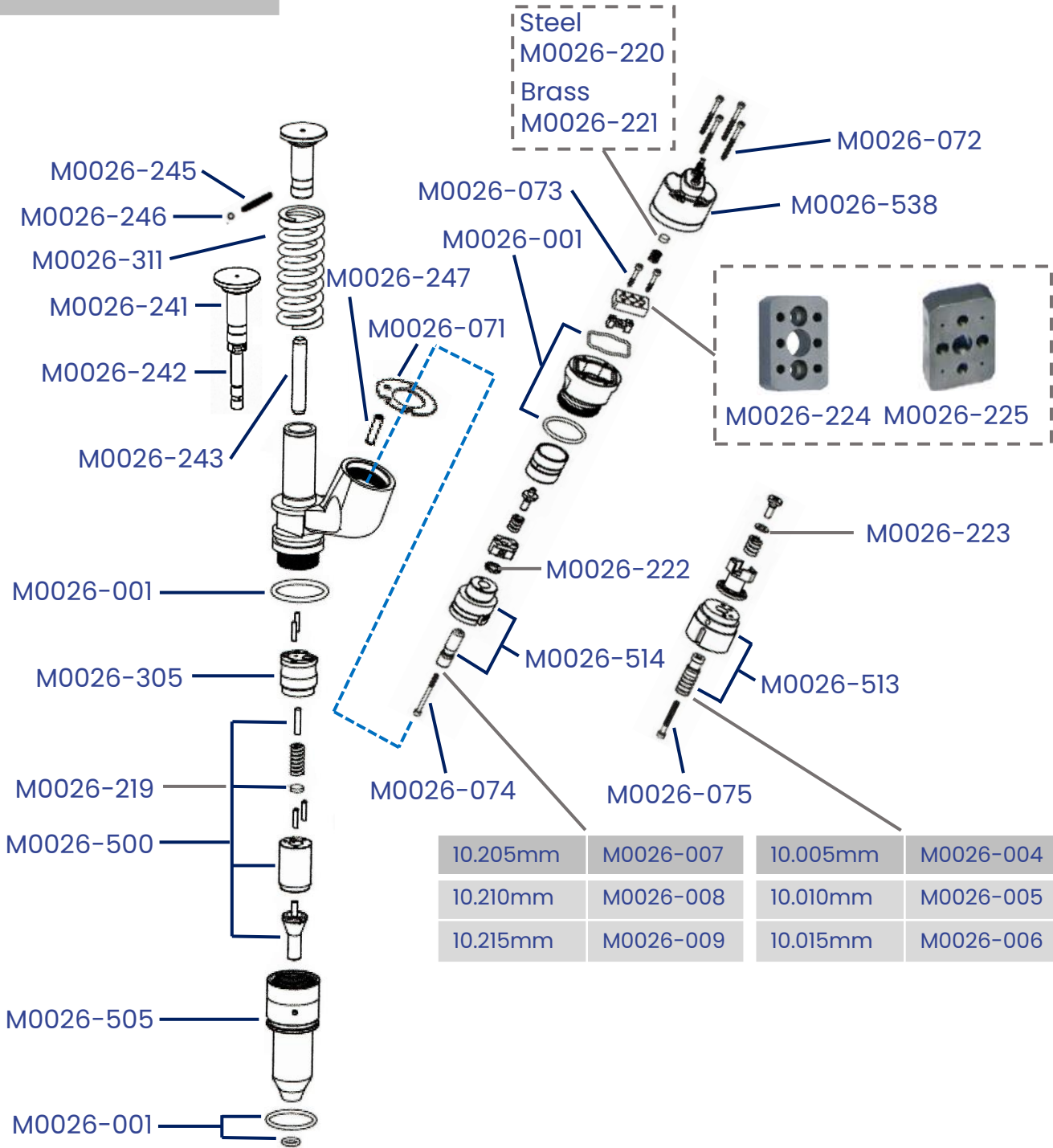

C Series EUI Injector Parts



CH10948

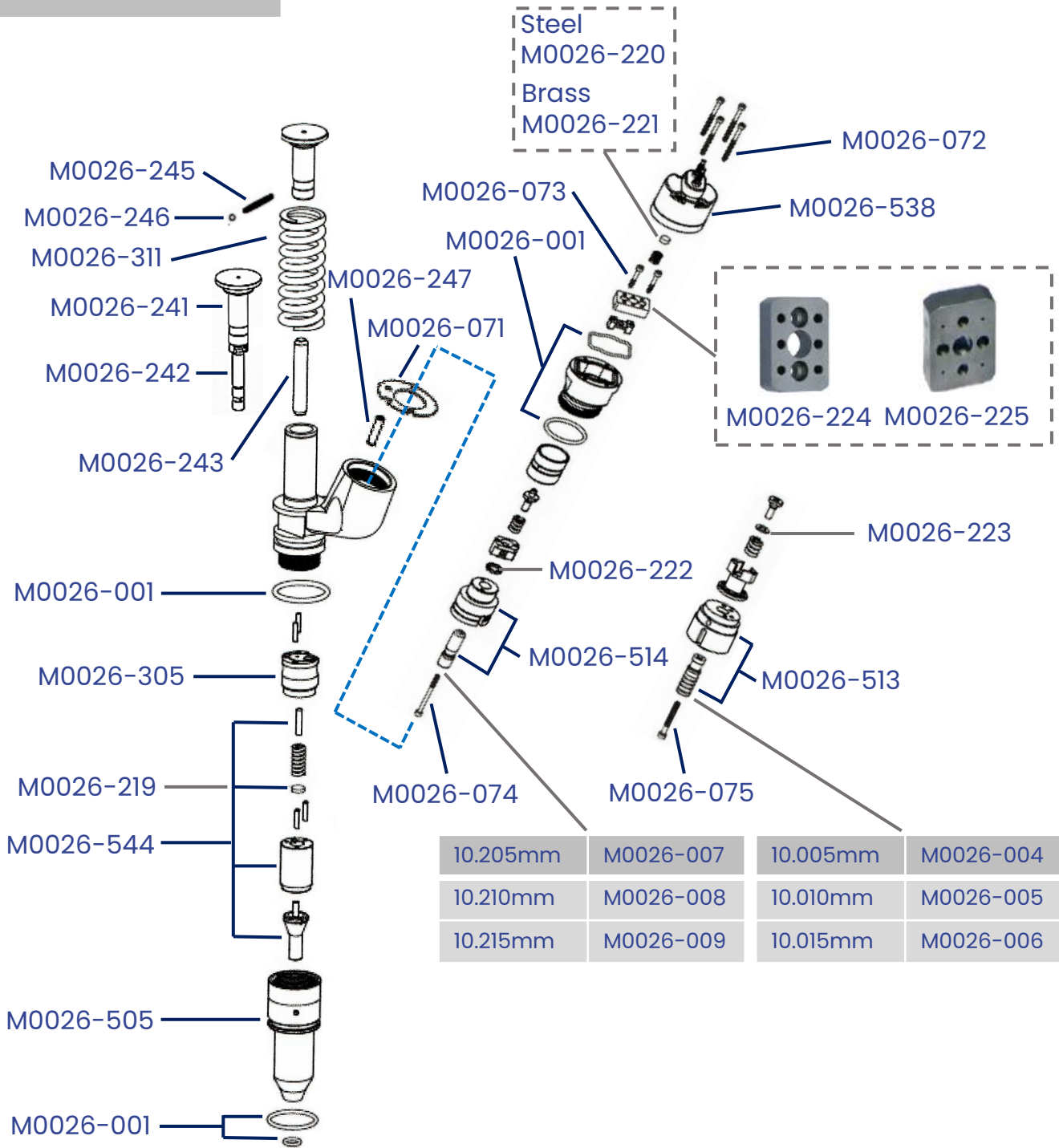

C Series EUI Injector Parts



CHI1945

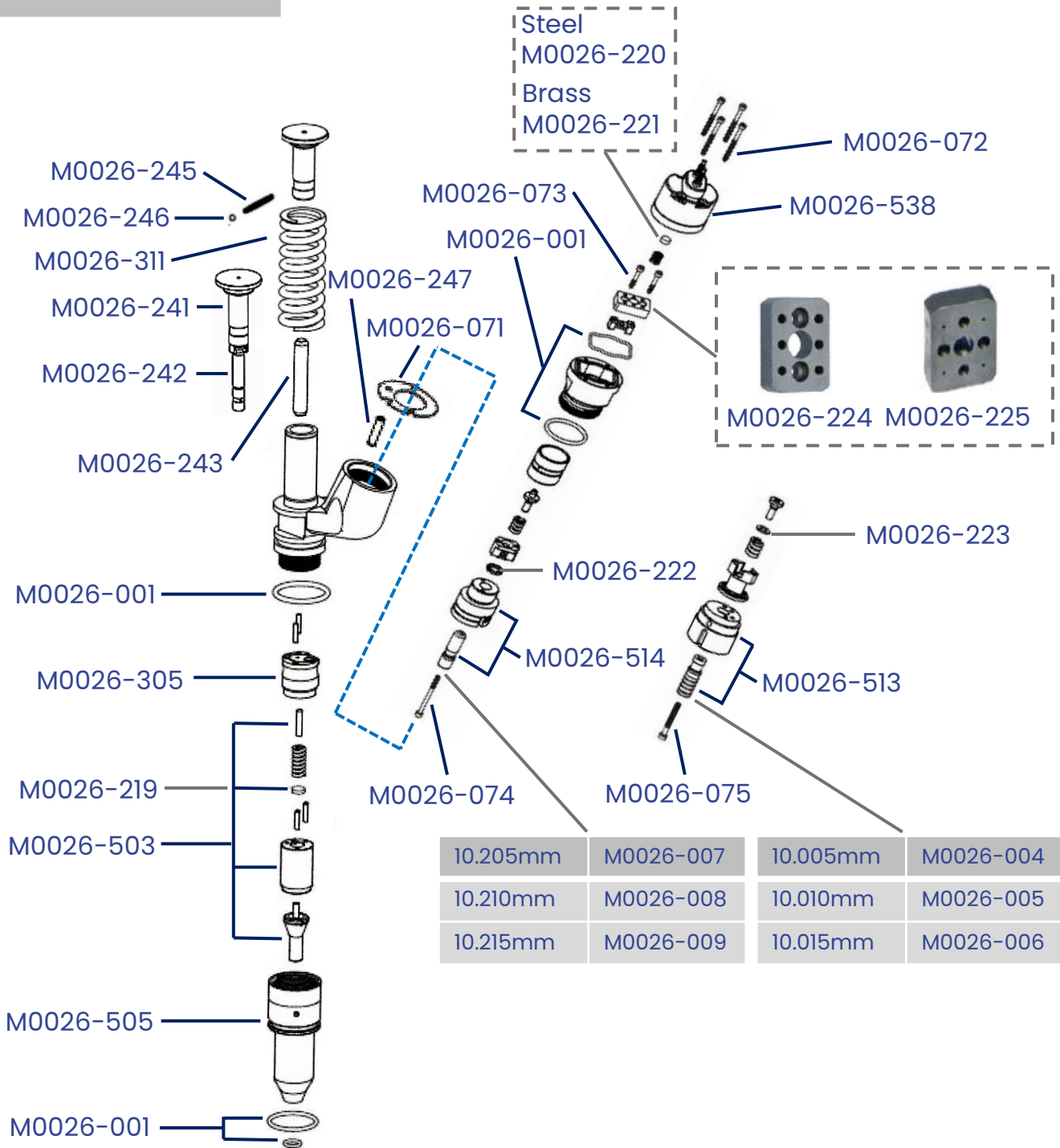

C Series EUI Injector Parts



CH12071

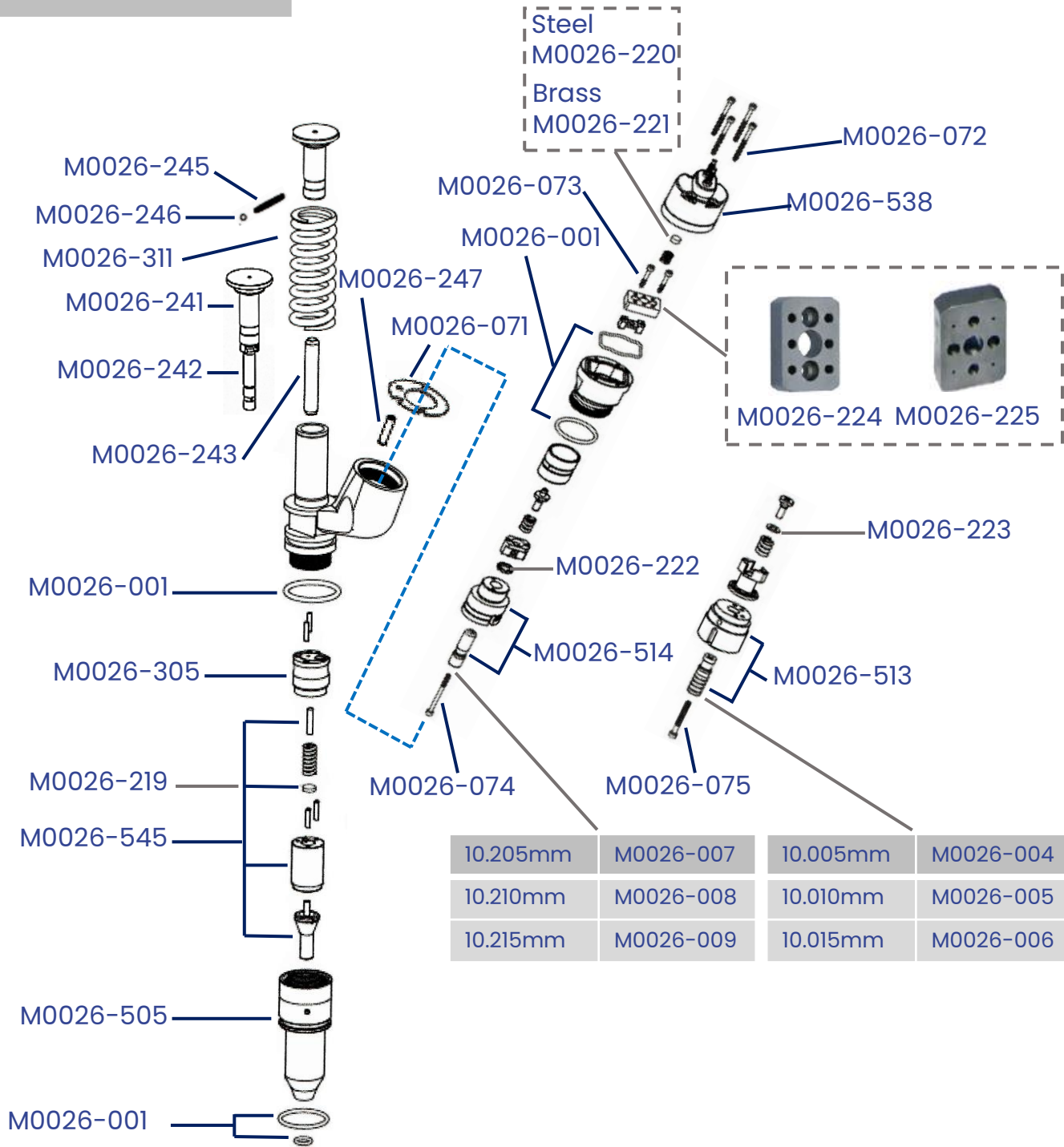

C Series EUI Injector Parts



249-0713

10R3262

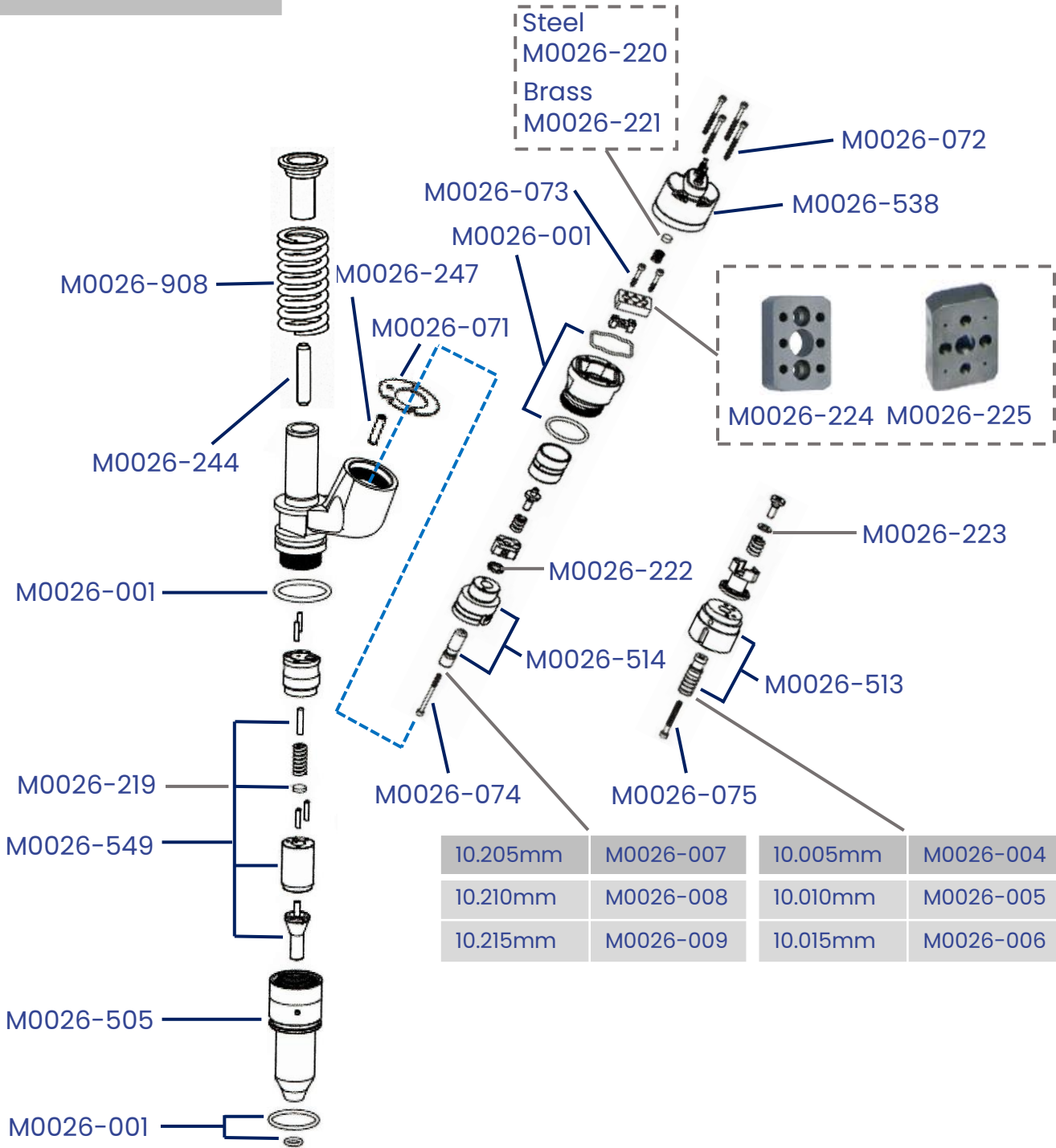

C Series EUI Injector Parts



356-1367

10R1273

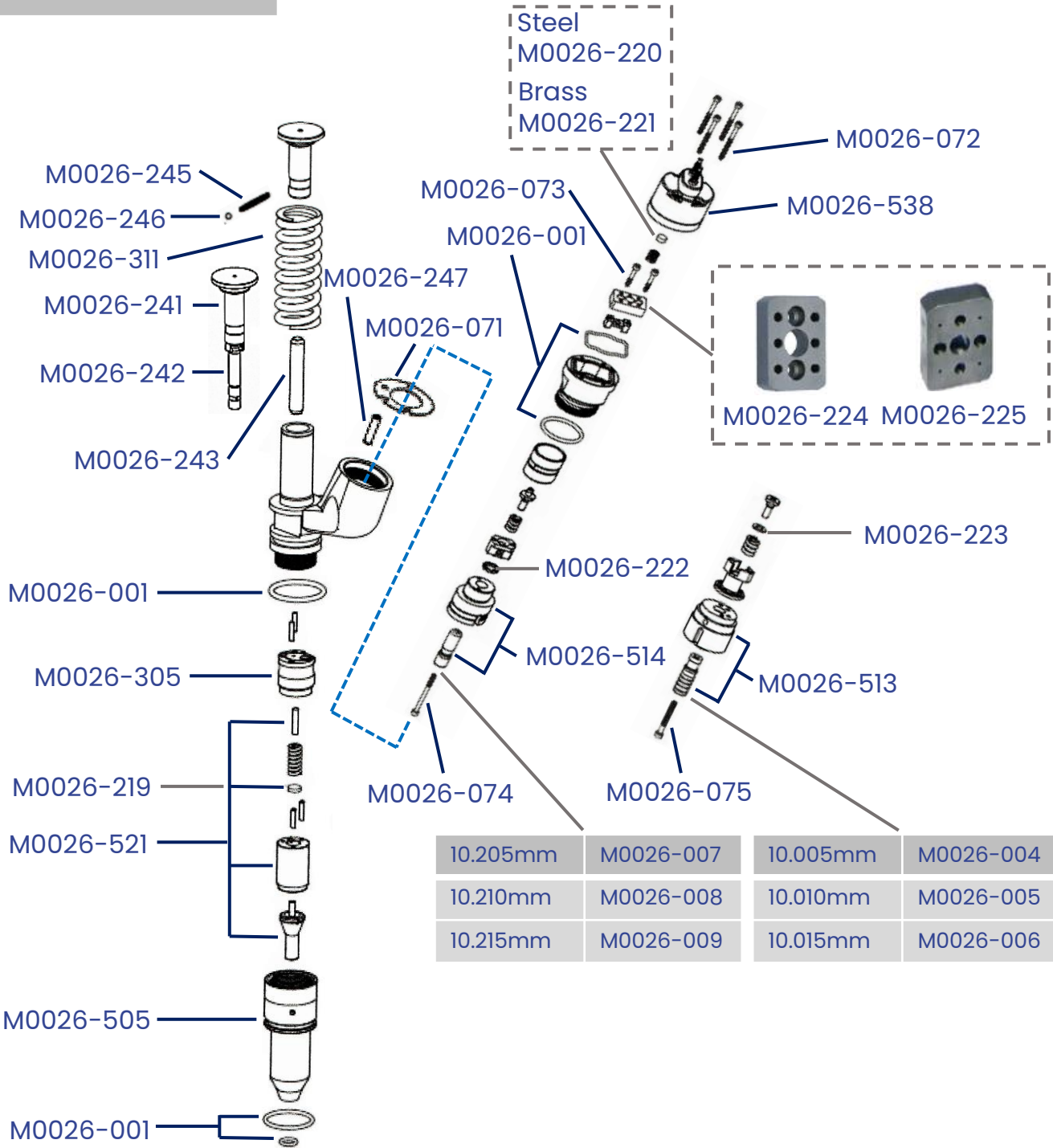

C Series EUI Injector Parts



229-5919

10R1000

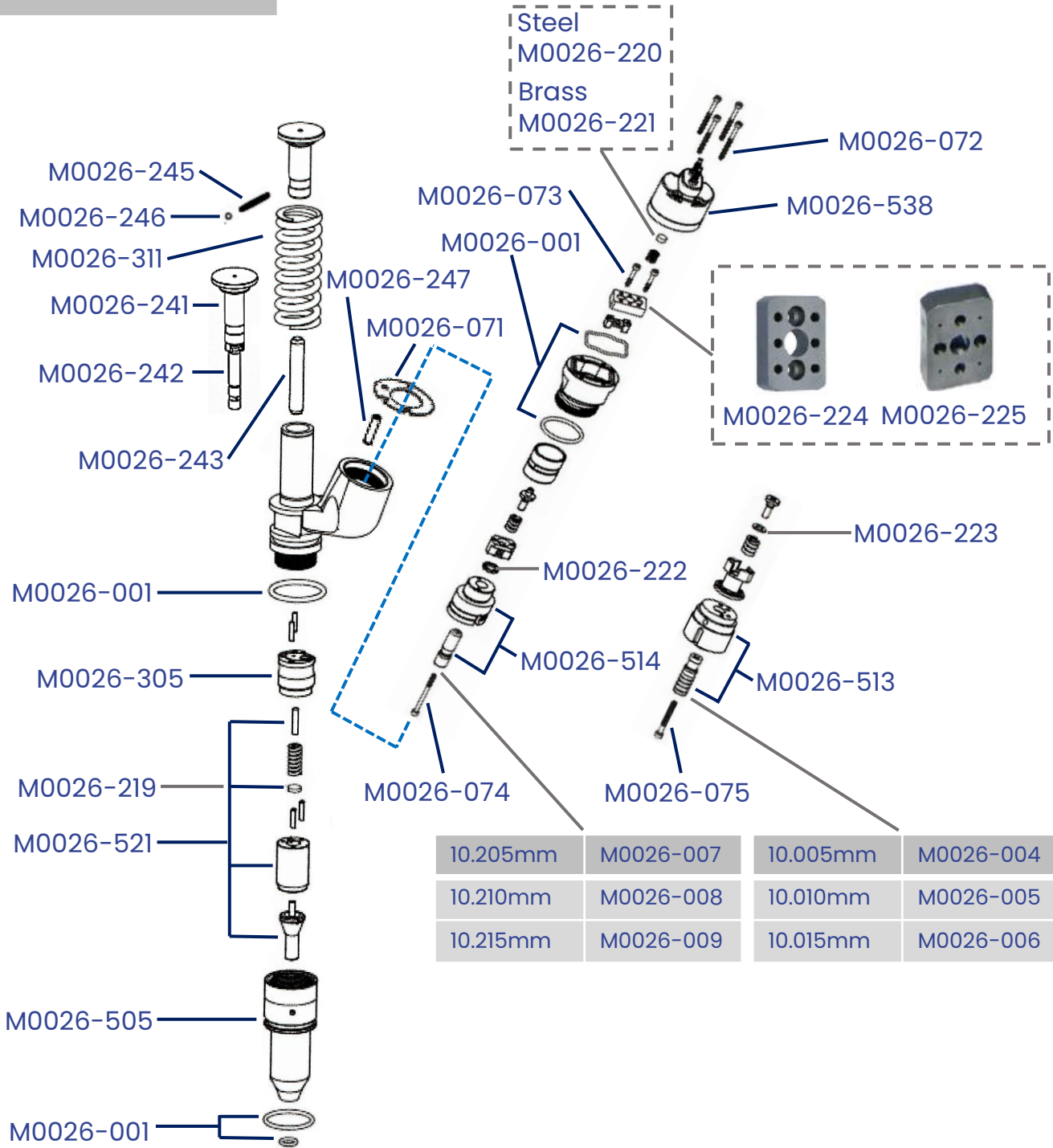

C Series EUI Injector Parts



211-3024

10R8502

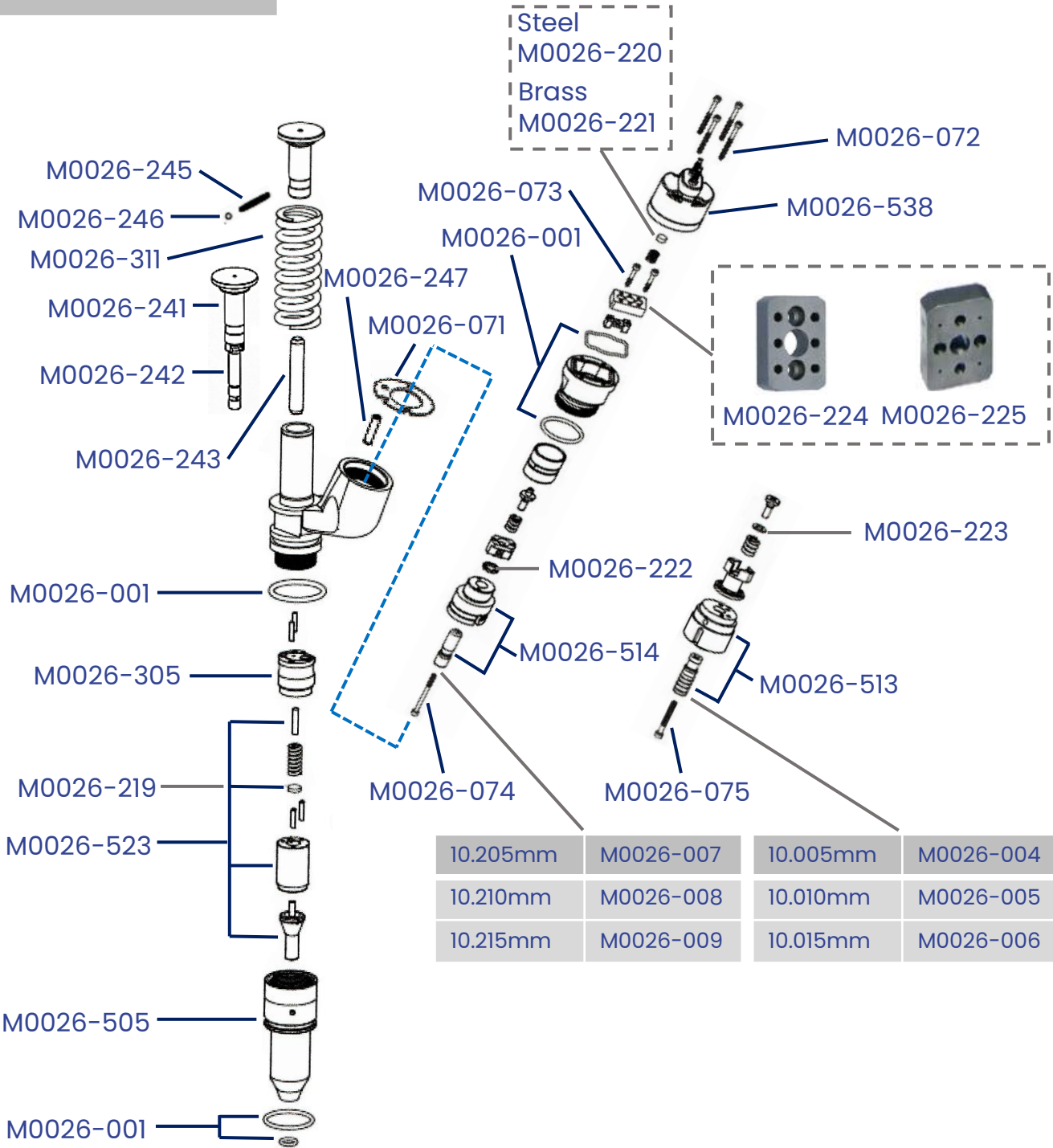

C Series EUI Injector Parts



211-3023

10R8501

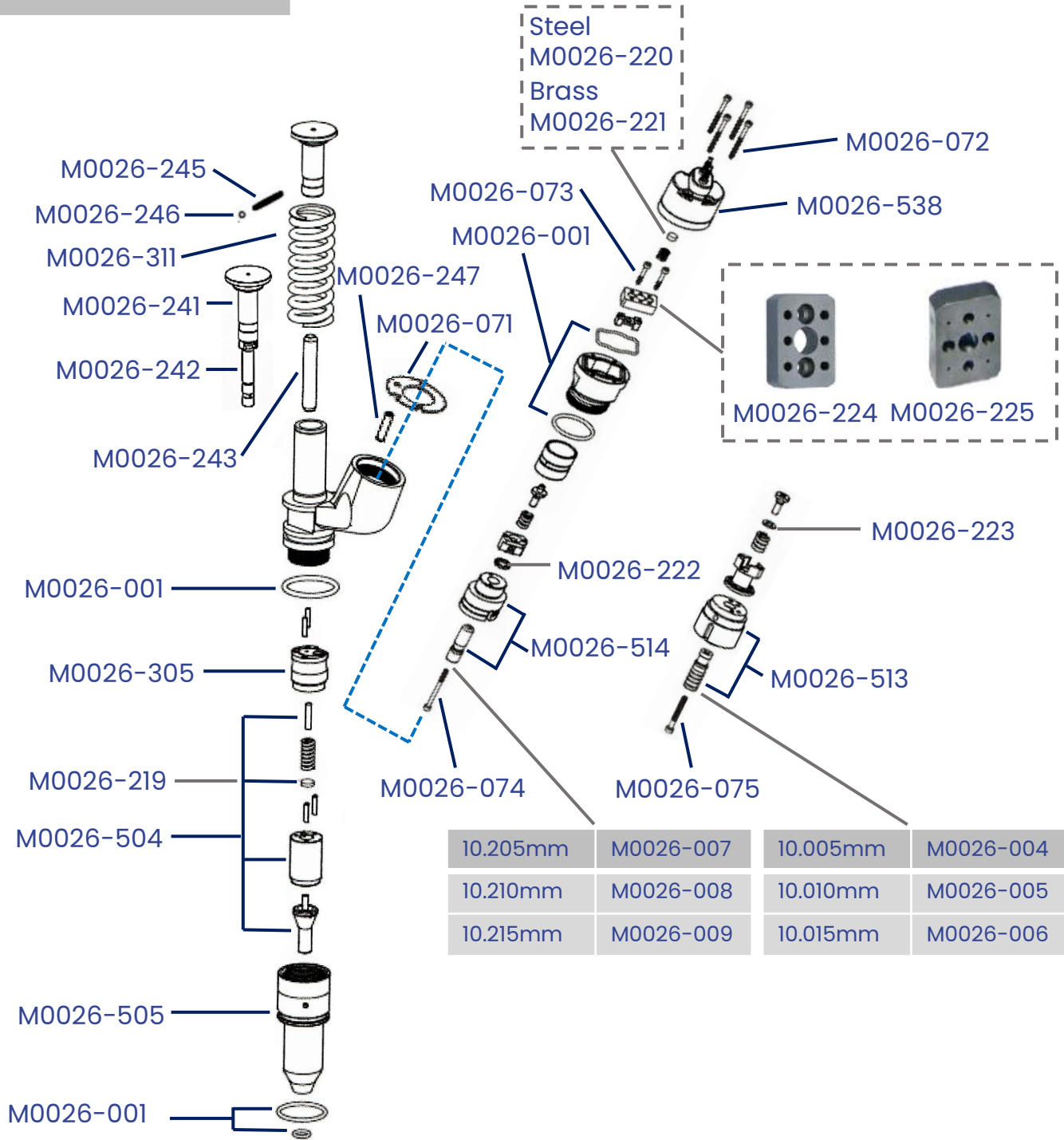

C Series EUI Injector Parts



249-0708

10R2977

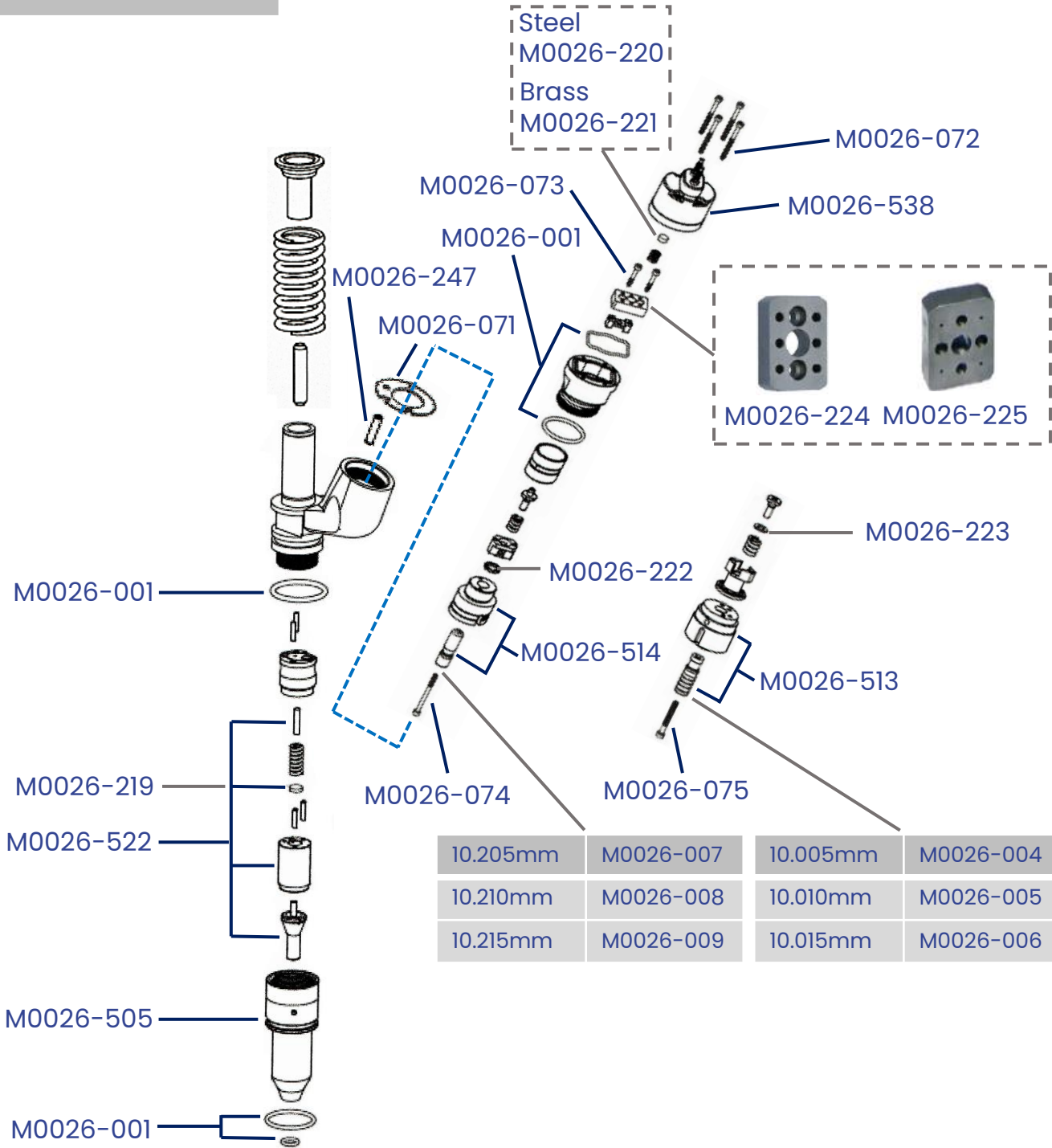

C Series EUI Injector Parts



CH12082

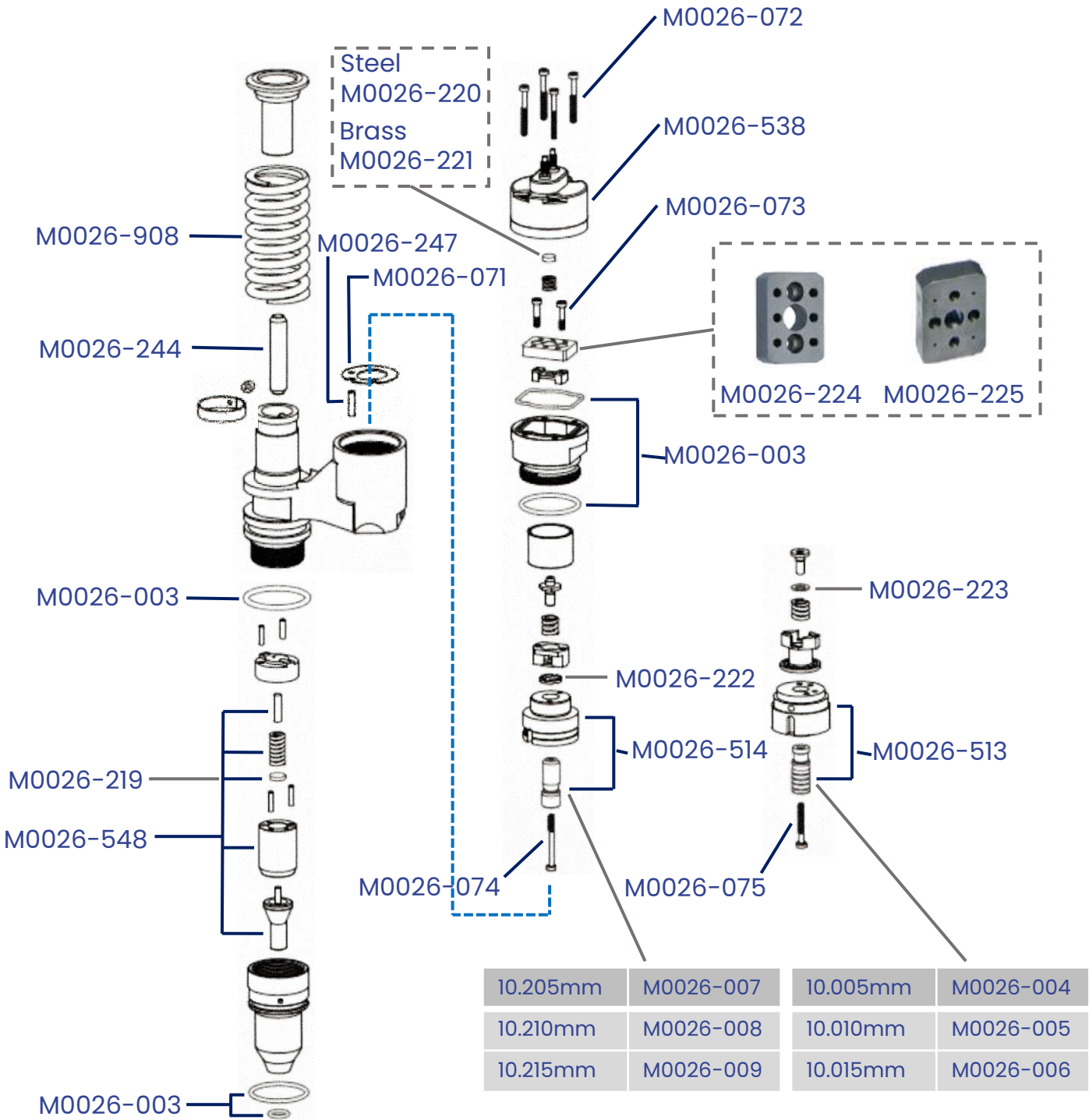

C Series EUI Injector Parts



212-3460

10R0960

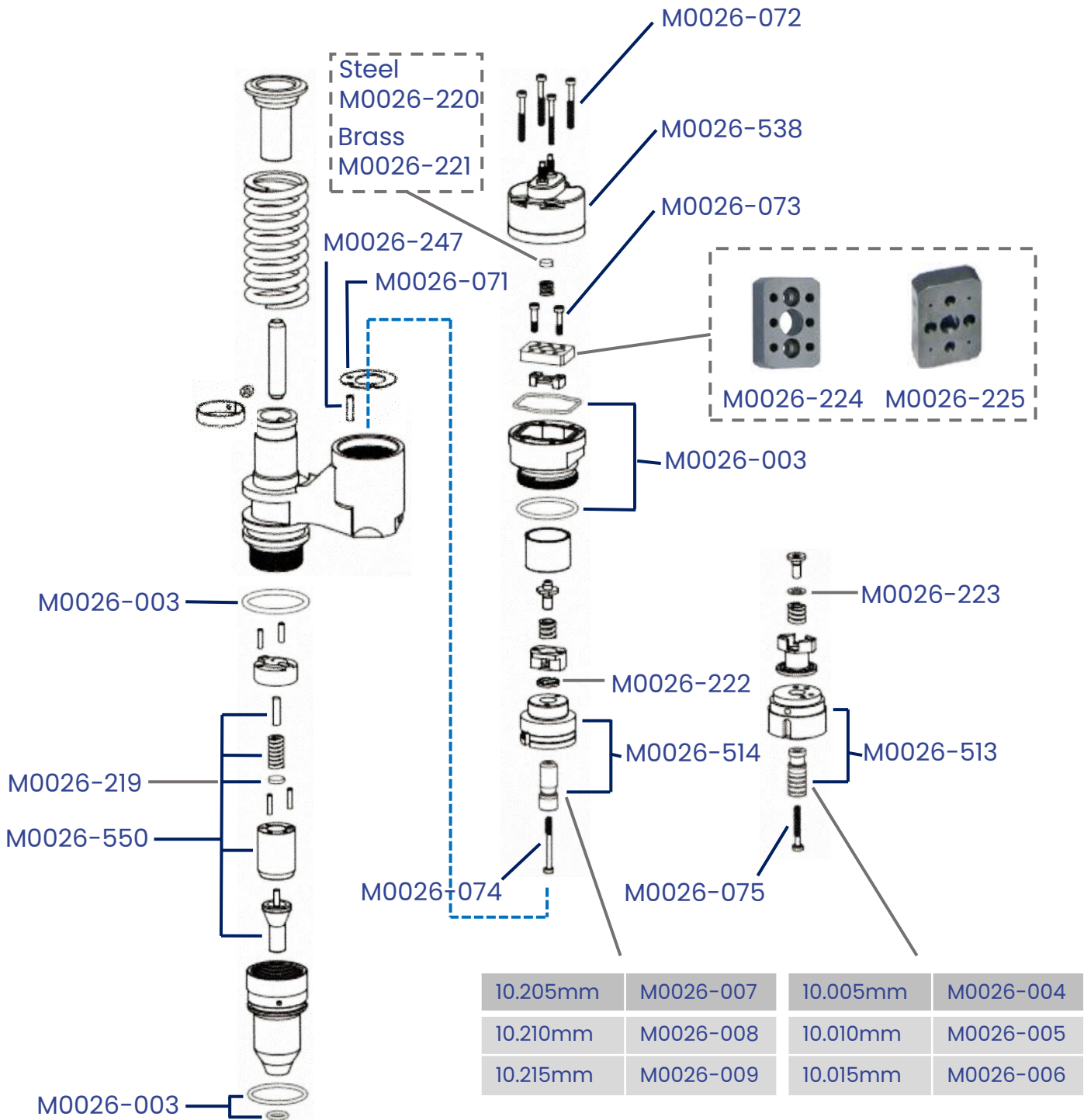

C Series EUI Injector Parts



212-3463

10R0963

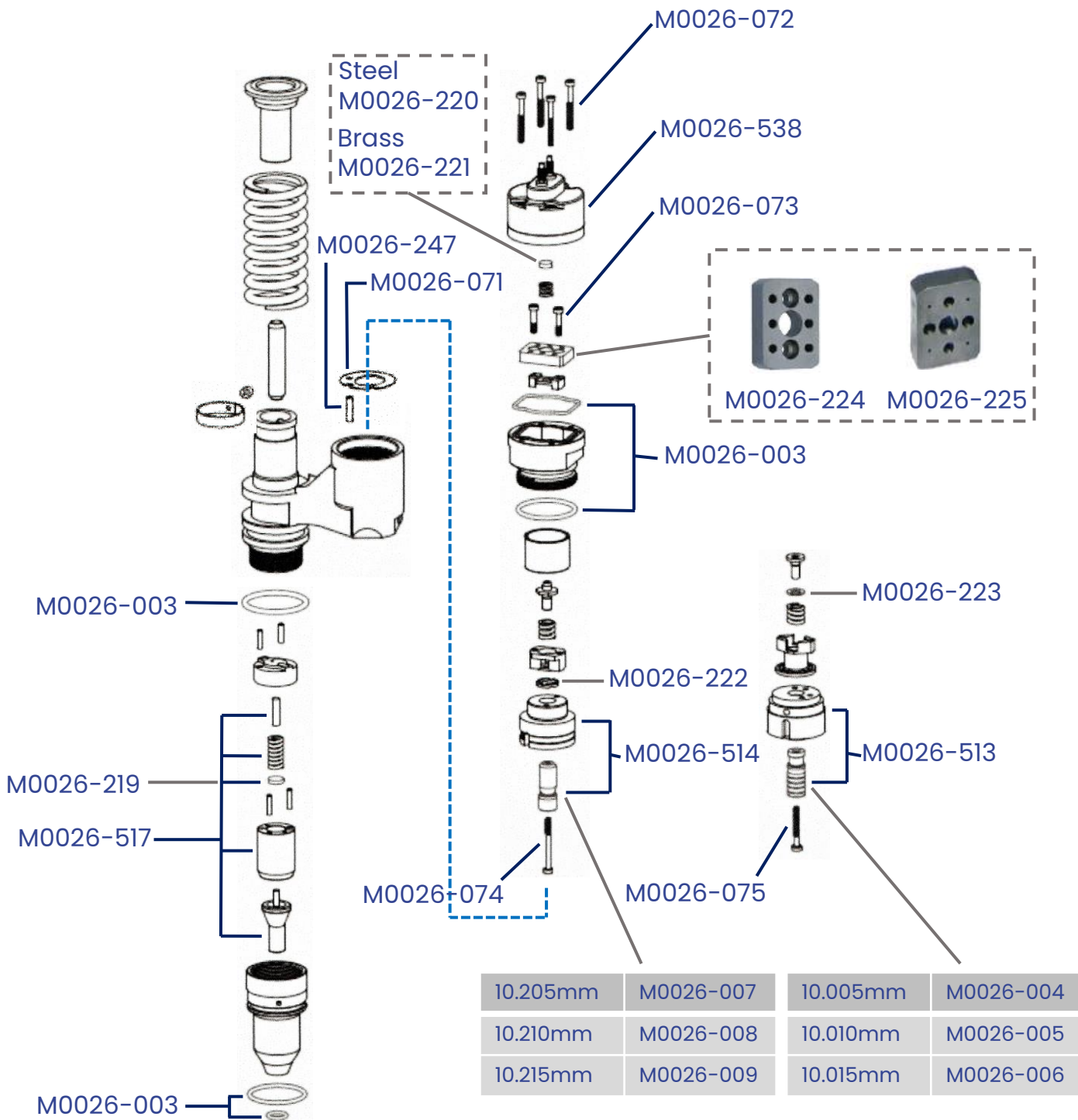

C Series EUI Injector Parts



211-3022

10R0956

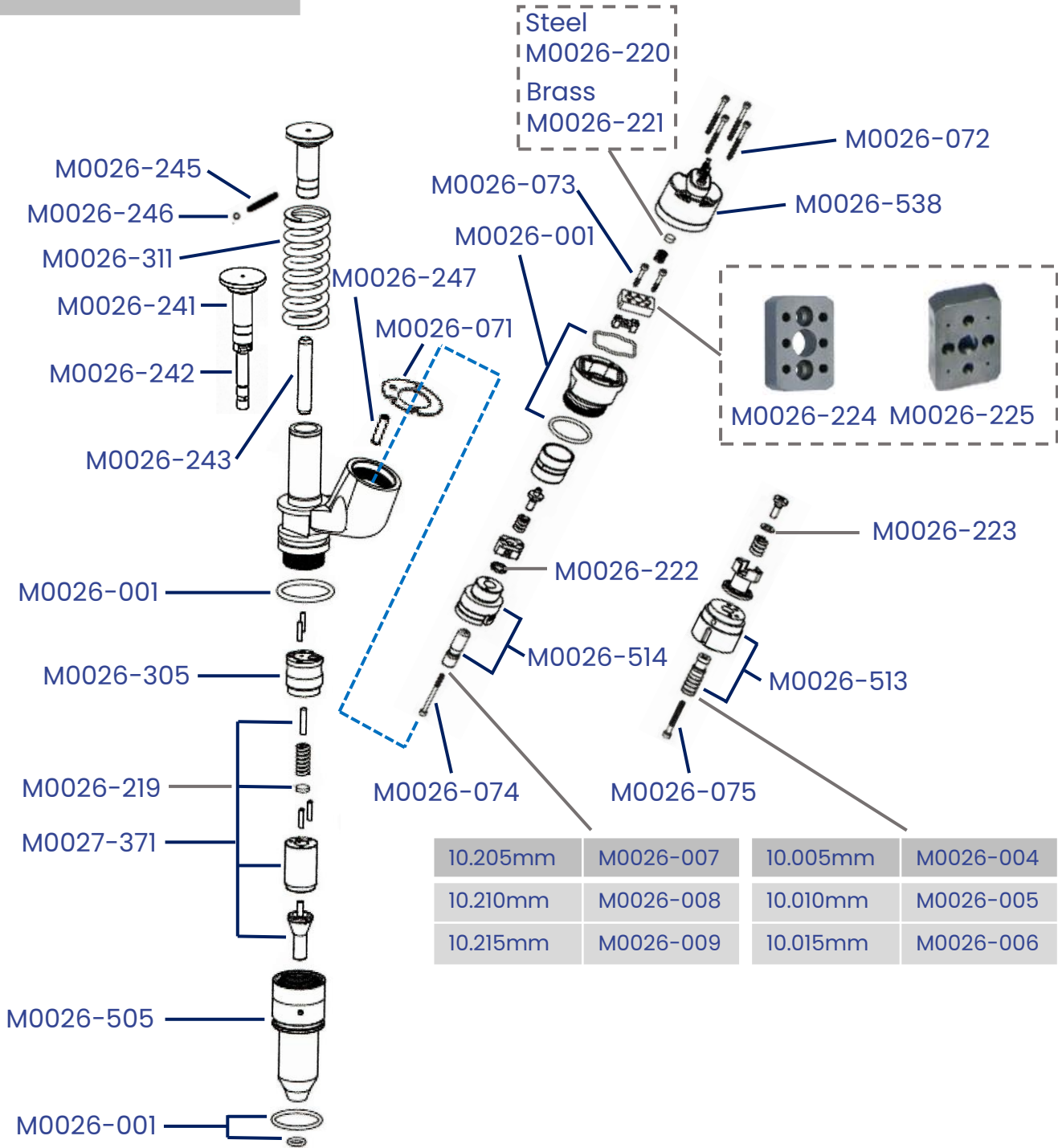

C Series EUI Injector Parts



211-3025

10R0955

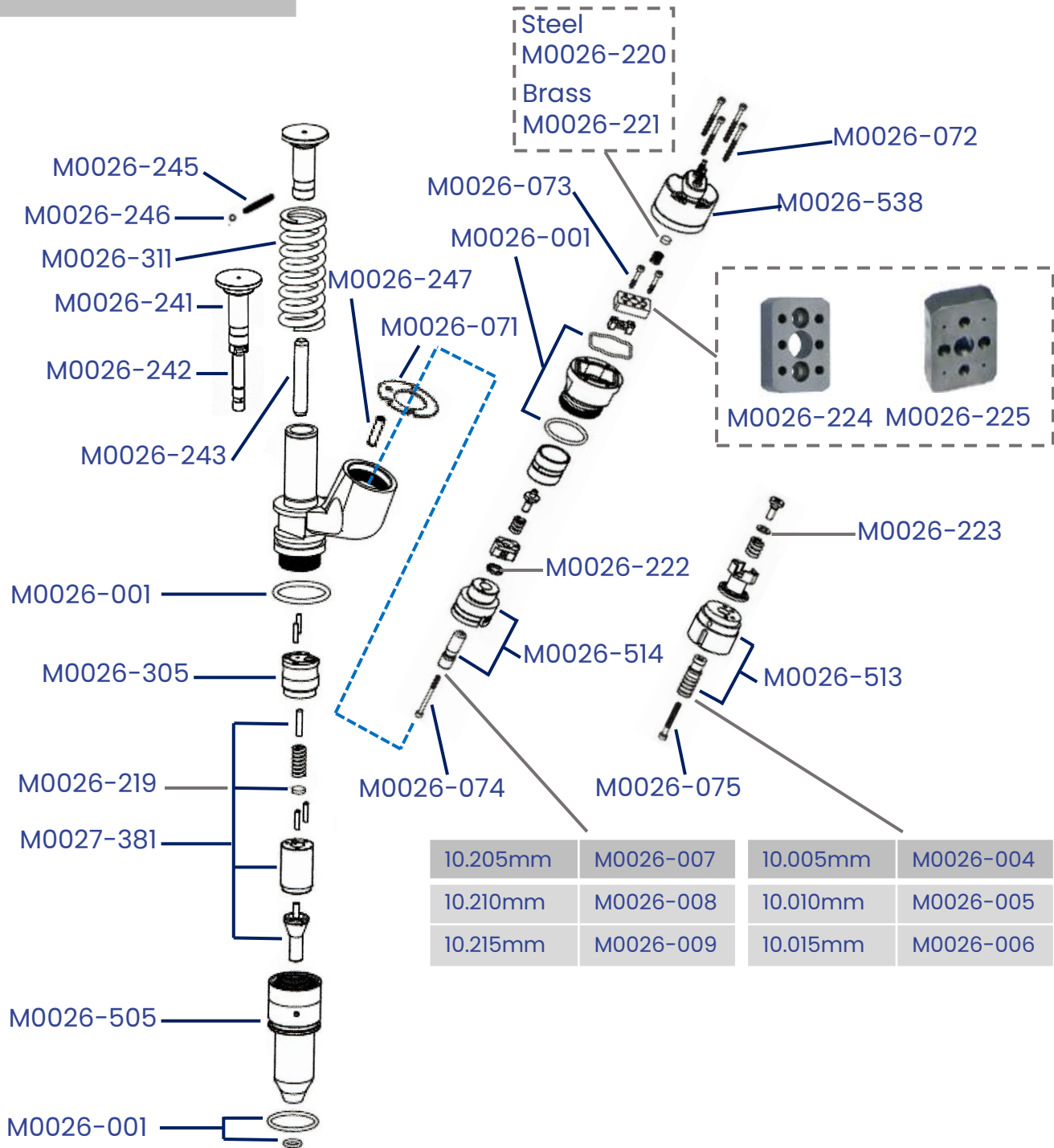

C Series EUI Injector Parts



Parts Index

Part no.	Description	Pack size
M0026-001	Seal kit	1
M0026-004	Control valve grooved 10.005mm	1
M0026-005	Control valve grooved 10.010mm	1
M0026-006	Control valve grooved 10.015mm	1
M0026-007	Control valve smooth 10.205mm	1
M0026-008	Control valve smooth 10.210mm	1
M0026-009	Control valve smooth 10.215mm	1
M0026-071	Deflector plate	6
M0026-072	Solenoid screws	4
M0026-073	Armature plate screws	8
M0026-074	Control valve screws smooth type	12
M0026-075	Control valve screws grooved type	12
M0026-222	Crinkly shims kit 1.90mm-2.05mm	160
M0026-241	Plunger guide	1
M0026-242	Plunger	1
M0026-243	Plunger	1
M0026-244	Plunger	1
M0026-245	Plunger locating spring	10
M0026-246	Ball	1
M0026-247	Control valve Dowel	1
M0026-305	Spacer	1
M0026-311	Spring	1
M0026-500	Nozzle group	1
M0026-501	Nozzle group	1
M0026-502	Nozzle group	1
M0026-503	Nozzle group	1
M0026-504	Nozzle group	1
M0026-505	Cap nut	1
M0026-513	Control valve assembly grooved	1
M0026-514	Control valve assembly smooth	1
M0026-517	Nozzle group	1
M0026-521	Nozzle group	1
M0026-522	Nozzle group	1
M0026-523	Nozzle group	1
M0026-538	Solenoid	1
M0026-544	Nozzle group	1
M0026-545	Nozzle group	1
M0026-548	Nozzle group	1
M0026-549	Nozzle group	1
M0026-550	Nozzle group	1
M0026-908	Spring	1
M0027-371	Nozzle Group	1
M0027-381	Nozzle Group	1

C Series EUI Injector Parts



Individual Adjustable items from kits

M0026-219

NOP Shims

Number	Size mm
M0028-2019	2.00
M0028-2020	2.05
M0028-2021	2.10
M0028-2022	2.15
M0026-048	2.20
M0026-049	2.25
M0026-050	2.30
M0026-051	2.35
M0026-052	2.40
M0026-053	2.45
M0026-054	2.50
M0026-055	2.55
M0026-056	2.60

M0026-221

Coil shim Brass

Number	Size mm
M0026-023	2.30
M0026-024	2.35
M0026-025	2.40
M0026-026	2.45
M0026-027	2.50
M0026-028	2.55
M0026-029	2.60
M0026-030	2.65
M0026-031	2.70
M0026-032	2.75
M0026-033	2.80
M0026-034	2.85
M0026-035	2.90

M0026-220

Coil shim steel

Number	Size mm
M0026-010	2.50
M0026-011	2.55
M0026-012	2.60
M0026-013	2.65
M0026-014	2.70
M0026-015	2.75
M0026-016	2.80
M0026-017	2.85
M0026-018	2.90
M0026-019	2.95
M0026-020	3.00
M0026-021	3.10
M0026-022	3.20

M0026-223

Armature shim

Number	Size mm
M0026-058	0.50
M0026-059	0.60
M0026-060	0.70
M0026-061	0.80
M0026-062	0.90
M0026-063	0.95
M0026-064	1.00
M0026-065	1.05
M0026-066	1.10
M0026-067	1.15
M0026-068	1.20
M0026-069	1.25
M0026-070	1.30

C Series EUI Injector Parts



Individual Adjustable items from kits

M0026-224

Armature plates

Number	Size mm
M0028-2757	6.60
M0028-2758	6.62
M0028-2759	6.64
M0028-2760	6.66
M0028-2761	6.68
M0028-2762	6.70
M0028-2763	6.72
M0028-2764	6.74
M0026-036	6.76
M0026-037	6.78
M0026-038	6.80
M0026-039	6.82
M0026-040	6.84
M0026-041	6.86

M0026-225

Armature plates

Number	Size mm
M0028-2765	8.01
M0028-2766	8.03
M0028-2767	8.05
M0028-2768	8.07
M0028-2769	8.09
M0028-2770	8.11
M0028-2771	8.13
M0026-042	8.15
M0026-043	8.17
M0026-044	8.19
M0026-045	8.21
M0026-046	8.23
M0026-047	8.25



Diesel Pump / Injector / Test and Repair Service

Suppliers of New and Remanufactured Pumps / Injectors

DPF Cleaning Service

Power Testing / Re-mapping

Technical Support

Test Equipment

Parts Sales

Injector Software Coding Solutions

Conference and Training Facilities

Merlin Diesel Systems Ltd | 189-191 Bradkirk Place | Walton Summit Centre | Preston | Lancashire | PR5 8AJ

TEST EQUIPMENT - Tel: +44 (0) 1772 694185

UK SALES - Tel: +44 (0) 1772 694130

EXPORT SALES - Tel: +44 (0) 1772 694133

EMAIL: testequipment@merlindiesel.com

 www.merlindiesel.com



BOSCH
Invented for life



Perkins



Stanadyne



hartridge ROBIEL